

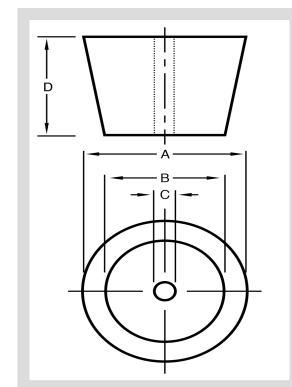

One-Hole Rubber Stoppers



Part#	Size	Dimensions (mm)				Dimensions (in)			
		Top (A)	Bottom (B)	Hole (C)	Length (D)	Top (A)	Bottom (B)	Hole (C)	Length (D)
CLS-000-1H-10B40	000	12	9	2.5	18	0.472	0.354	0.098	0.709
CLS-00-1H-10B40	00	15	10	3	25	0.591	0.394	0.118	0.984
CLS-0-1H-10B40	0	17	13	3	25	0.669	0.512	0.118	0.984
CLS-01-1H-10B40	1	19	14	4	25	0.748	0.551	0.157	0.984
CLS-02-1H-10B40	2	20	16	5	25	0.787	0.630	0.197	0.984
CLS-03-1H-10B40	3	24	18	5	25	0.945	0.709	0.197	0.984
CLS-04-1H-10B40	4	26	20	5	25	1.024	0.787	0.197	0.984
CLS-05-1H-10B40	5	27	23	5	25	1.063	0.906	0.197	0.984
CLS-05.5-1H-10B40	5 1/2	28	24	5	25	1.102	0.945	0.197	0.984
CLS-06-1H-10B40	6	32	26	5	25	1.260	1.024	0.197	0.984
CLS-06.5-1H-10B40	6 1/2	34	27	5	25	1.339	1.063	0.197	0.984
CLS-07-1H-10B40	7	37	30	5	25	1.457	1.181	0.197	0.984
CLS-07.5-1H-10B40	7 1/2	39	31	5	25	1.535	1.220	0.197	0.984
CLS-08-1H-10B40	8	41	33	5	25	1.614	1.299	0.197	0.984
CLS-08.5-1H-10B40	8 1/2	43	36	5	25	1.693	1.417	0.197	0.984
CLS-09.5-1H-10B40	9	45	37	5	25	1.772	1.457	0.197	0.984
CLS-09.5-1H-10B40	9 1/2	46	38	5	25	1.811	1.496	0.197	0.984
CLS-10-1H-10B40	10	50	42	5	25	1.969	1.654	0.197	0.984



One-Hole Rubber Stoppers

Part#	Size	Dimensions (mm)				Dimensions (in)			
		Top (A)	Bottom (B)	Hole (C)	Length (D)	Top (A)	Bottom (B)	Hole (C)	Length (D)
CLS-10.5-1H-10B40	10 1/2	53	45	5	25	2.087	1.772	0.197	0.984
CLS-11-1H-10B40	11	56	48	5	25	2.205	1.890	0.197	0.984
CLS-11.5-1H-10B40	11 1/2	63	50	5	25	2.480	1.969	0.197	0.984
CLS-12-1H-10B40	12	64	54	5	25	2.520	2.126	0.197	0.984
CLS-13-1H-10B40	13	68	58	5	25	2.677	2.283	0.197	0.984
CLS-13.5-1H-10B40	13 1/2	75	62	5	35	2.953	2.441	0.197	1.378
CLS-14-1H-10B40	14	90	75	5	39	3.543	2.953	0.197	1.535
CLS-15-1H-10B40	15	103	83	5	39	4.055	3.268	0.197	1.535